

CORDLESS 3-IN-1

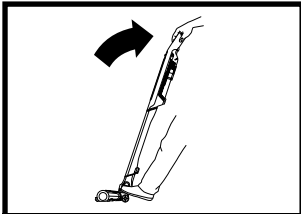

UPRIGHT

The brushroll is activated when the hand vacuum is connected and powered on, and the handle is tilted back.

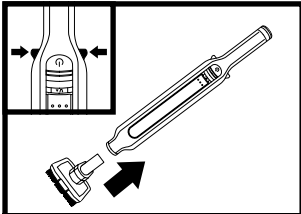

ABOVE-FLOOR
HAND VACUUM

To detach the hand vacuum, slide the release tabs on both sides of the handle and lift it off the wand. Attach an accessory by sliding it into the nozzle. To remove the accessory, slide the release tabs on the handle. To reattach the hand vacuum, slide the nozzle over the wand until it clicks into place.

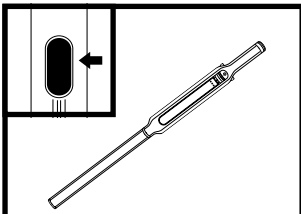

ABOVE-FLOOR
WAND

To detach the floor nozzle, step on the nozzle while pressing the release button at the bottom of the wand. Lift the wand to remove it. Reattach by sliding the wand over the nozzle neck until it clicks into place.

EMPTYING THE DUST CUP

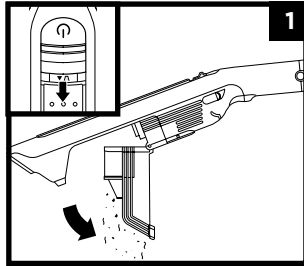

With the power off, slide the release button forward, and the dust cup will swing open. Tap the dust screen lightly to knock off dust and debris.

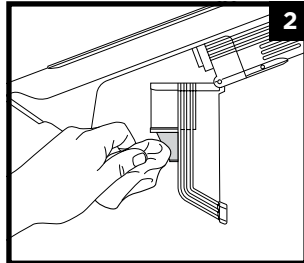

Wipe dust screen lightly with a dry cloth to remove dust and dirt.

Please make sure to read the enclosed Shark® Owner's Guide prior to using your vacuum.

Shark® WANDVAC® SYSTEM PET

CORDLESS 3-in-1

QUICK START GUIDE

For questions, visit us online
at sharkclean.com/support

Register your vacuum at
registeryourshark.com

visit [qr.sharkclean.com](http://qr.sharkclean.com/ws640seriesmanual)
/ws640seriesmanual or

SCAN HERE
USING YOUR SMARTPHONE CAMERA



FOR FULL INSTRUCTIONS
& REPLACEMENT PARTS

WS640



Shark®



@sharkcleaning

© 2022 SharkNinja Operating LLC. SHARK and WANDVAC are registered trademarks of SharkNinja Operating LLC. POWERFINS is a trademark of SharkNinja Operating LLC.

WS640Series_QSG_MP_220223

WHAT'S INSIDE:

- A** Hand Vacuum
- B** Wand
- C** PowerFins™ Floor Nozzle
- D** WANDVAC® System Docking Station
- E** Battery Pack
- F** Hand Vacuum Storage Clip (pre-attached)
- G** Duster Crevice Tool
- H** Pet Multi-Tool (WS642)

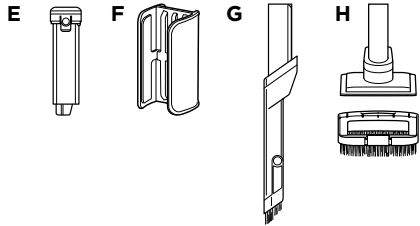

1. Slide the wand onto the neck of the floor nozzle until it clicks into place.
2. Slide the hand vacuum nozzle over the wand until it clicks into place.
3. Make sure the dock plate is facing upright. Slide the charging post into the slot on the back of the dock until it clicks into place.
4. Place the dock on the floor near a wall outlet. Plug the wall charger into the outlet, then connect the cord to the port on the back of the charging post.
5. Store cleaning accessories on the mount on the dock plate.

For proper operation, ensure all components are completely connected and clicked into place.

For complete maintenance instructions, see the enclosed Owner's Guide.
 For additional parts and accessories, visit sharkaccessories.com.
 For additional batteries and charging accessories, visit sharkclean.com/batteries.

ASSEMBLY

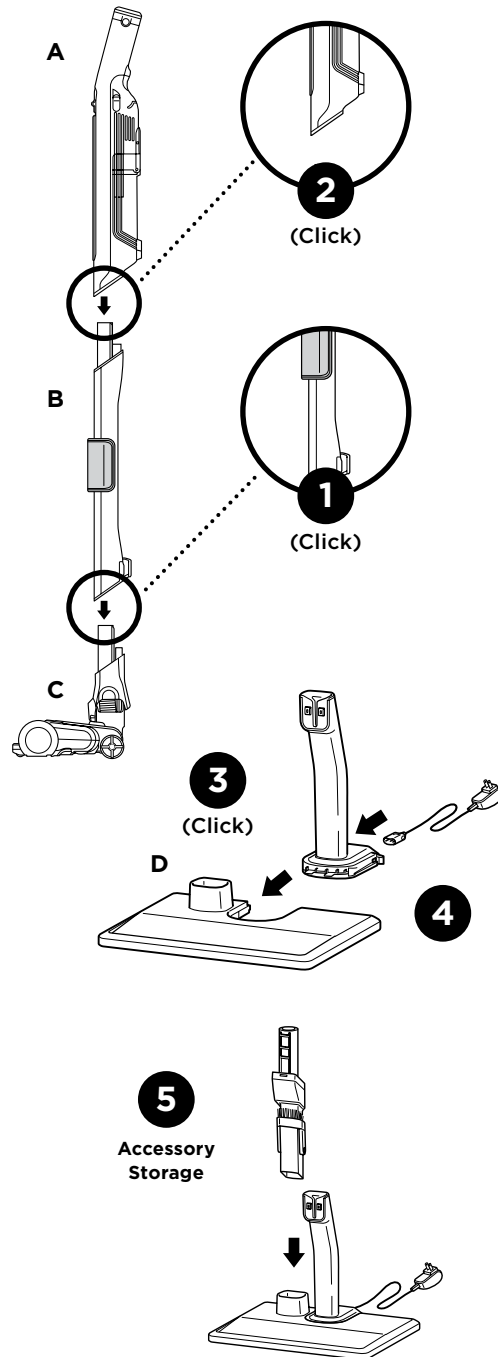

POWER SETTINGS

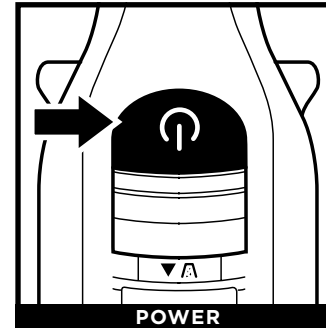

Press the On/Off button on the handle to turn on power. To turn off power, press the button again.

LI-ION BATTERY

Charging



NOTE: Full charge takes approximately 3.5 hours per battery.
 LEDs will shut off 5 minutes after achieving full charge.

In Use

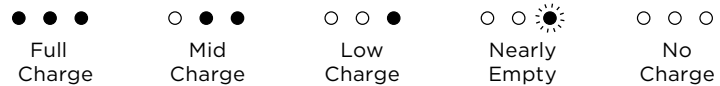

CHARGING OPTIONS

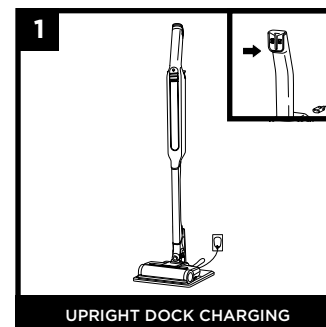

UPRIGHT DOCK CHARGING

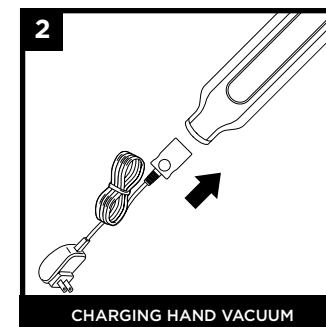

CHARGING HAND VACUUM

Make sure the contacts on the wand or hand vacuum are aligned with the contacts on the charging dock or charging post. When the unit is docked properly, the charging lights on the hand vacuum will blink, indicating that charging has begun. When charging is complete, all three indicator lights will remain on for 5 minutes, then shut off.