

Please be sure to read the enclosed Shark® Owner's Guide prior to using your unit.

Shark Navigator™ SWIVEL PRO COMPLETE

QUICK START GUIDE

WHAT'S INSIDE

- A** Vacuum Pod
- B** Handle & Hose
- C** Wand
- D** Hose Holder
- E** 5.5" Crevice Tool
- F** Dusting Brush
- G** Upholstery Tool

ASSEMBLY

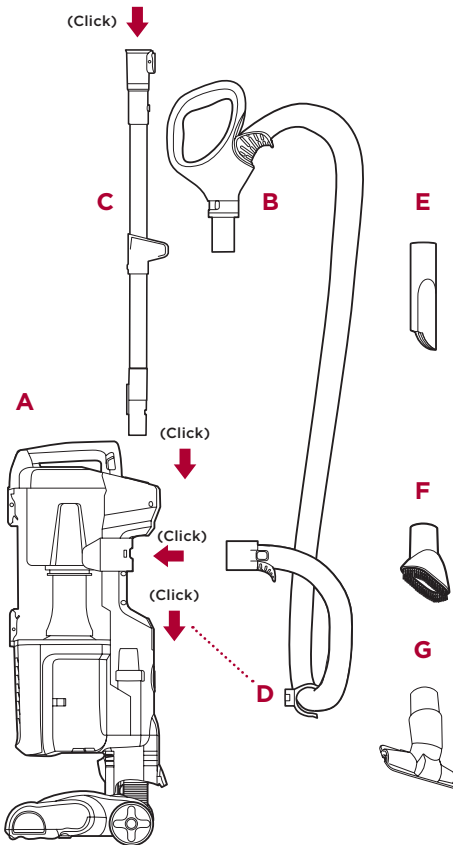

NOTE: For proper operation, ensure all parts are firmly **CLICKED** into place.

EMPTYING THE DUST CUP

Empty the dust cup after each use.

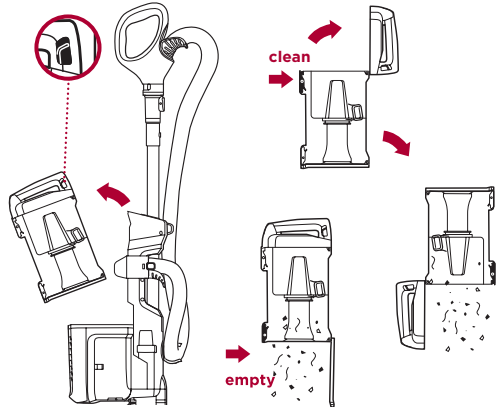

MAINTENANCE

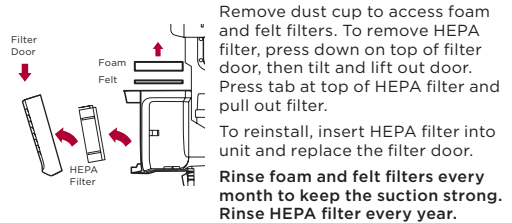

Rinse filters with water only and allow them to air-dry completely before reinstalling. Between washes, tap loose dirt from filters as needed.

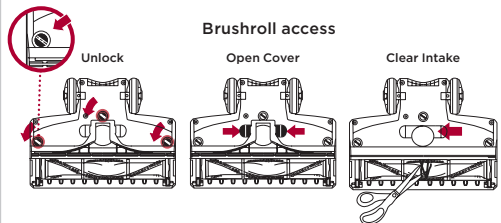

Use a coin to turn the locks counterclockwise until they click open, then lift the cover to access the brushroll. Clear the debris intake.

2 WAYS TO CLEAN

FLOOR CLEANING



1

HARD FLOOR

Press switch to I for hard floor surfaces.



2

CARPET

Press switch to II for low and high pile carpet cleaning.

3

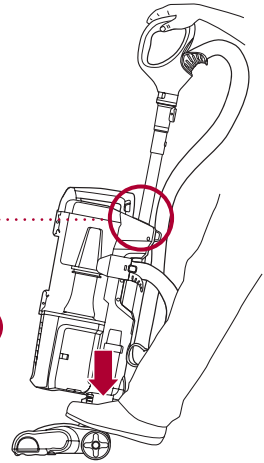

To engage brushroll, step on floor nozzle and tilt handle back.

ABOVE-FLOOR CLEANING

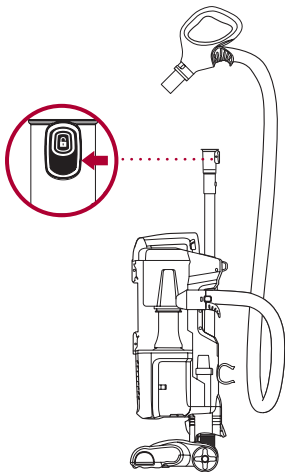

1

To clean above-floor areas, remove the handle from the wand. Or for more reach, remove the wand from the pod.

OR

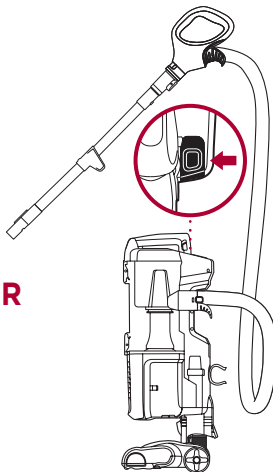

2

Attach a cleaning accessory to handle or wand.

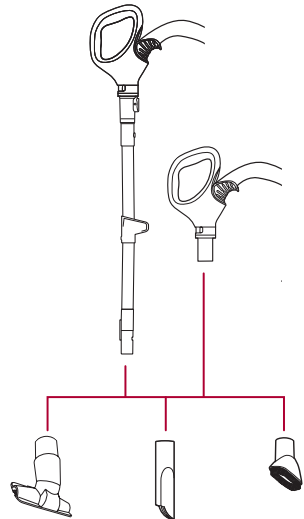

For additional parts and accessories, visit sharkaccessories.com

For additional information or to register your product, visit us online at sharkclean.com

