

SETUP

STEP 1 PREP THE ROBOT

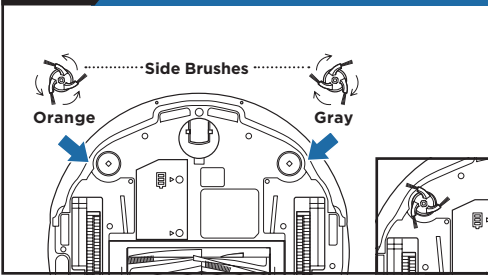

Snap the 2 side brushes onto the pegs on the bottom of the robot. When installed correctly, the orange brush will spin counterclockwise and the gray brush will spin clockwise. The side brushes are located in the red packaging.

STEP 2 SET UP THE BASE

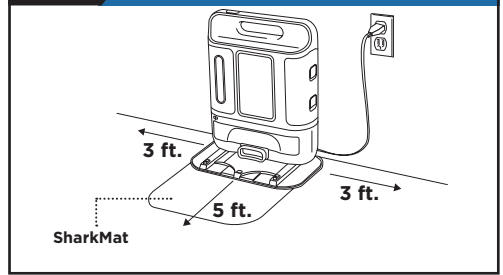

Find a **permanent** location for the base. Place it with its back against a wall, in an area with a good Wi-Fi signal. Remove any objects that are closer than 3 ft. from either side or closer than 5 ft. from the front.

Place the SharkMat under the base on all floor types for additional stability when the robot docks.

STEP 3 PLUG IN THE BASE

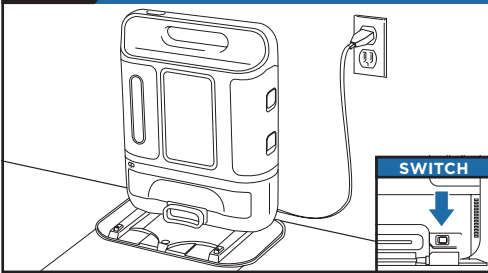



- Plug the base power cord into an electrical outlet.
- Turn the power switch on the back of the base to the (I) ON position.

The **green** power indicator light  on the base will illuminate when the base has power.

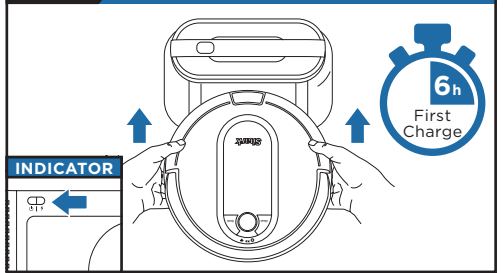
STEP 4 CHARGE THE ROBOT

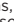

To charge, place robot with its **BACK** side against base.

- Turn power switches on **BOTH** robot and base to (I) ON position.
- When charging begins, robot will beep and **BLUE** charging indicator light  on base will **PULSE**. When robot is fully charged,  light will turn **SOLID** blue.

NOTE: Every time the robot returns to the dock, it will make a loud noise as it empties debris. This is normal and no cause for concern.

OPTIMIZING YOUR HOME FOR CLEANING

STEP 5 PREP YOUR HOME

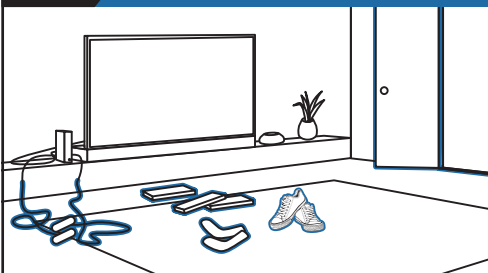

Clear cords and remove small objects like toys, clothing, or drapes from floors. Open interior doors in rooms you want your robot to clean. For best results, run your robot in well-lit conditions.

STEP 6 DOWNLOAD THE SHARKCLEAN® APP



Scan QR code with your phone's camera to quickly find and download the app

Search "SharkClean" in the app store. Some of the exclusive features in the app:

- Cleaning Reports
- Extended Clean
- Scheduled Cleaning
- Cleaning Modes

WHAT TO EXPECT

As your robot learns your home, you may need to make some small adjustments to optimize performance.

WIFI TROUBLESHOOTING

Restart your phone

- Turn off phone, wait a few minutes, then turn it back on and connect to Wi-Fi.

Reboot your robot

- Make sure the power switch on the back of the BASE is in the ON position.
- Press the power switch on the side of the robot to the OFF position. Wait 10 seconds, then press it to the (I) ON position.

Reboot your router

- Unplug the router power cable for 30 seconds, then plug it back in. Allow several minutes for your router to reboot completely.

Two Easy Steps If You're Stuck:

Having trouble connecting to your robot? Call **1-888-228-5531** for robot support.

For additional help, visit: sharkclean.com/support

- How-to Videos
- FAQs
- Troubleshooting
- Tips & Tricks

Smart Home Setup

To set up voice control using Google Home or Amazon Alexa, visit sharkclean.com/app for instructions.

AVOID MOVING THE ROBOT OR BASE

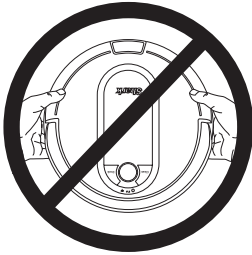

While your robot is cleaning, do not pick it up and move it, or move the charging base—this will impact the robot's ability to map your home.

CHECK BASE FILL LEVEL

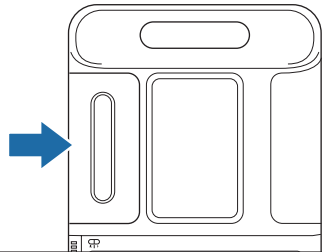

During the first few weeks, your robot will empty more often than usual. Check the fill level regularly. Home environments vary, and the bin may fill up quicker in some homes.

LIGHTING CONDITIONS

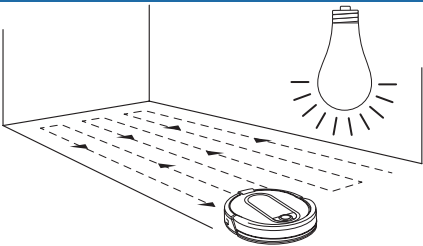

For best results, run your robot in well-lit conditions. If you run your robot at night, keep the lights on in the areas to be cleaned.

DOORWAYS AND THRESHOLDS

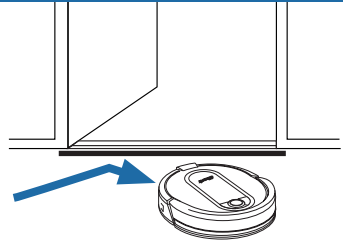

Your robot can easily climb over most thresholds, but if one is higher than an inch, block it off with a BotBoundary® strip.

© 2022 SharkNinja Operating LLC. BOTBOUNDARY, SHARK and SHARKCLEAN are registered trademarks of SharkNinja Operating LLC. APPLE, the Apple logo, and iPhone are trademarks of Apple Inc., registered in the U.S. and other countries. APP STORE is a service mark of Apple Inc., registered in the U.S. and other countries. GOOGLE, GOOGLE ASSISTANT, GOOGLE PLAY, the Google Play logo, and Android are trademarks of GOOGLE LLC.