

## CORDLESS 3-IN-1

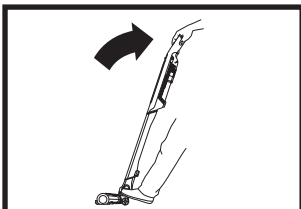

### UPRIGHT

The brushroll is activated when the hand vacuum is connected and powered on, and the handle is tilted back.

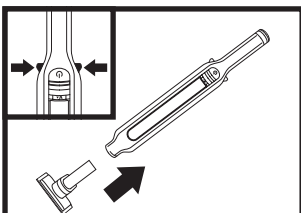

### ABOVE-FLOOR HAND VACUUM

To detach the hand vacuum, slide the release tabs on both sides of the handle and lift it off the wand. Attach an accessory by sliding it into the nozzle. To remove the accessory, slide the release tabs on the handle. To reattach the hand vacuum, slide the nozzle over the wand on until it clicks into place.

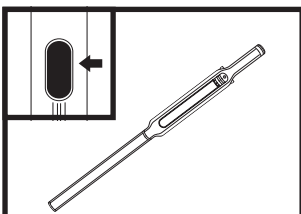

### ABOVE-FLOOR WAND

To detach the floor nozzle, step on the nozzle while pressing the release button at the bottom of the wand. Lift the wand to remove it. Reattach by sliding the wand over the nozzle neck until it clicks into place.

## EMPTYING THE DUST CUP

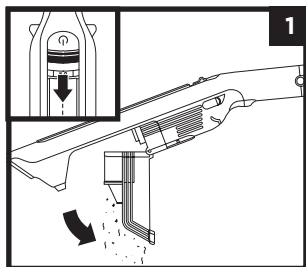

With the power off, slide the release button forward, and the dust cup will swing open. Tap the dust screen lightly to knock off dust and debris.

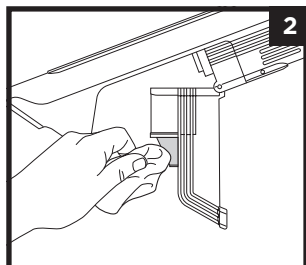

Wipe dust screen lightly with a dry cloth to remove dust and dirt.

Please make sure to read the enclosed Shark® Owner's Guide prior to using your vacuum.

# Shark

 WANDVAC™  
SYSTEM PET

## CORDLESS 3-in-1

## QUICK START GUIDE

For questions, visit us online at  
[sharkclean.ca/customer-care](https://sharkclean.ca/customer-care)

Register your vacuum at  
[registeryourshark.com](https://registeryourshark.com)



# Shark



@sharkcleaningcanada

© 2021 SharkNinja Operating LLC. SHARK is a registered trademark of SharkNinja Operating LLC. POWERFINS and WANDVAC are trademarks of SharkNinja Operating LLC.

WS630C Series\_QSG\_E\_MP\_Mv5

WS630C  
WS632C

## WHAT'S INSIDE:

- A** Hand Vacuum
- B** Wand
- C** PowerFins™ Floor Nozzle
- D** WANDVAC™ System Docking Station
- E** Battery Pack
- F** Duster Crevice Tool
- G** Pet Multi-Tool

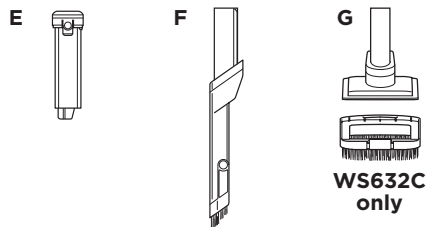

1. Slide the wand onto the neck of the floor nozzle until it clicks into place.
2. Slide the hand vacuum nozzle over the wand until it clicks into place.
3. Make sure the dock plate is facing upright. Slide the charging post into the slot on the back of the dock until it clicks into place.
4. Place the dock on the floor near a wall outlet. Plug the wall charger into the outlet, then connect the cord to the port on the back of the charging post.
5. Store cleaning accessories on the mount on the dock plate.

For proper operation, ensure all components are completely connected and clicked into place.

## ASSEMBLY

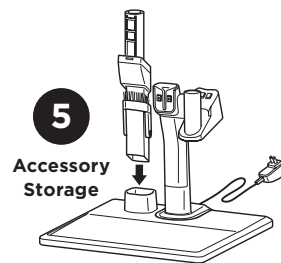
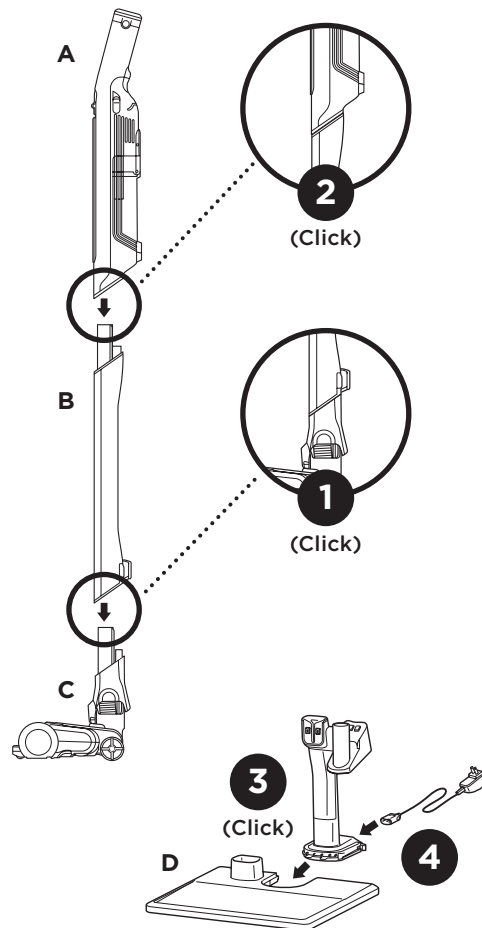

## POWER SETTINGS

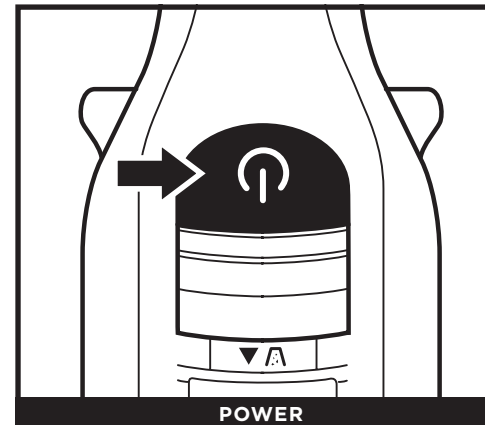

Press the On/Off button on the handle to turn on power. To turn off power, press the button again.

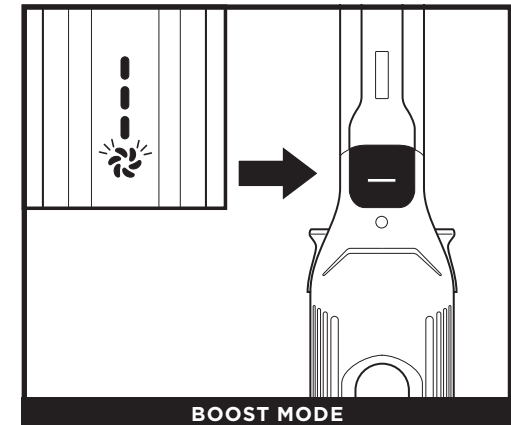

For an added boost of power, push and hold the Boost button on the handle. The Boost icon will blink white while in this mode. Release the button to return to standard power.

## LI-ION BATTERY

### Charging

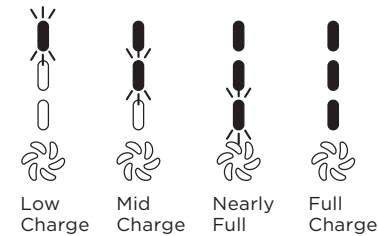

### In Use

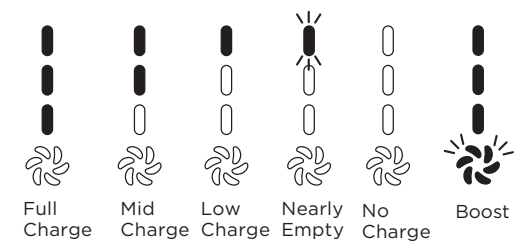

## CHARGING OPTIONS

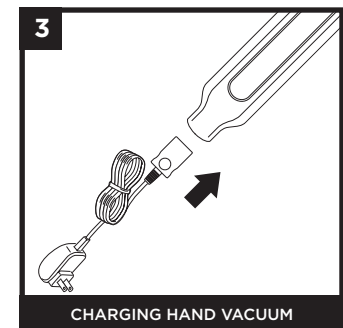
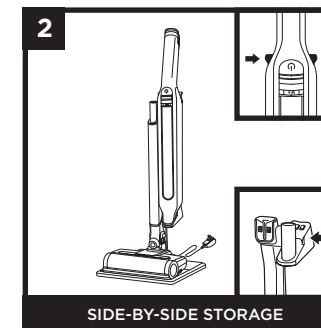
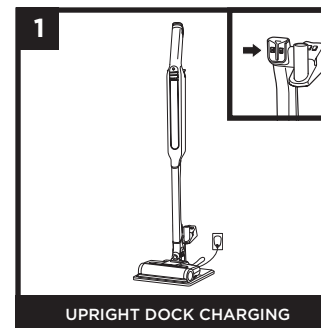

Make sure the contacts on the wand or hand vacuum are aligned with the contacts on the charging dock or charging post. When docked properly, the charging lights on the hand vacuum will blink, indicating that charging has begun. When charging is complete, all three indicator lights will remain on for 5 minutes, then shut off.

For complete maintenance instructions, see the enclosed Owner's Guide.

For additional parts and accessories, visit [sharkaccessories.com](http://sharkaccessories.com).

For additional batteries and charging accessories, visit [sharkclean.com/batteries](http://sharkclean.com/batteries).